

PLATE GIRDER SCHEDULE							
MARK	FL	REACTIONS	FLANGE	WEB	DEPTH		REMARK
		N-E S-W	N-E S-W	R			
MG 21	7th	4700K 2200K	4" x 30"	36" x 100"	108"		A 36
MG 22	7th	1600K 2000K	2" x 24"	36" x 56"	60"		A 36
MG 23	7th	1900K 4000K	5" x 30"	42" x 80"	96"		GR 42
MG 24	5th	4400K 2000K	6" x 48"	24" x 36"	48"		GR 42
MG 25	7th	4100K 2800K	5" x 30"	VARIABLES	VARIABLES		A 36
MG 26	5th	2600K 2000K	6" x 48"	24" x 36"	48"		GR 42
MG 27	5th	3000K 3800K	3" x 14"	24" x 26"	30"		GR 42
MG 28	2nd	2500K 2500K	4" x 14"	15" x 56"	44"		GR 50
MG 29	3rd	1000K 1000K	3" x 7"	18" x 32"	30"		GR 50
MG 30	2nd	2700K 2800K	2" x 22"	17" x 32"	30"		GR 50
MG 31	1st	2000K 1800K	2" x 22"	17" x 32"	30"		GR 50
MG 32	1st	2000K 1800K	16" x 2"	1" x 16"	18"		GR 50

PLATE GIRDER SCHEDULE (Cont'd)							
MARK	FL	REACTIONS	FLANGE	WEB	DEPTH		REMARK
		N-E S-W	N-E S-W	R			
MG 24	7th	90"	90"	16" x 7"	1" x 12"	18"	GR 50
MG 25	7th	40"	40"	7" x 14"	1" x 15"	18"	GR 50
MG 26	5th	180"	780"	16" x 3"	1" x 21"	21"	GR 42
MG 27	5th	100"	300"	16" x 3"	1" x 26"	33"	GR 42
MG 28	6th	200"	200"	16" x 3"	1" x 18"	24"	GR 42
MG 29	14th	30"	30"	7" x 11"	1" x 13"	15"	GR 50
MG 30	14th	50"	50"	10" x 1"	1" x 13"	15"	GR 50
MG 31	14th	150"	150"	2" x 22"	1" x 21"	24"	GR 50
MG 32	14th	150"	150"	2" x 22"	1" x 21"	24"	GR 50

NOTES:
 1. PLATE GIRDER STIFFENERS SHALL BE FITTED STIFFENERS AND TO BE PROVIDED ON EACH SIDE OF WEB. STIFFENERS SHALL BE ATTACHED TO WEB WITH MIN. 1/8" FILLET WELD ON EACH FACE OR STIFFENER.
 2. MILL THE WEB PLATES OF BUILT UP GIRDERS SHOWN ON THIS DWG. FOR TYPICAL BUILT UP GIRDER DETAIL AND WELDING SEE DWG. 11-24.

LEGEND:
 (T) - TENSILE FORCE
 (C) - COMPRESSIVE FORCE

RECTOR NOTE
 FOR BUILT WELDING SEE FIELDWORK DWG LISTED BELOW

DATE: 7/30/85
 BY: [Signature]
 CHECKED: [Signature]
 DATE: 8/1/85

DESCRIPTION OF REVISION

NO.	DATE	DESCRIPTION OF REVISION
1	7/30/85	ISSUED FOR CONSTRUCTION
2	8/1/85	REVISED PER FIELDWORK DWG 11-24

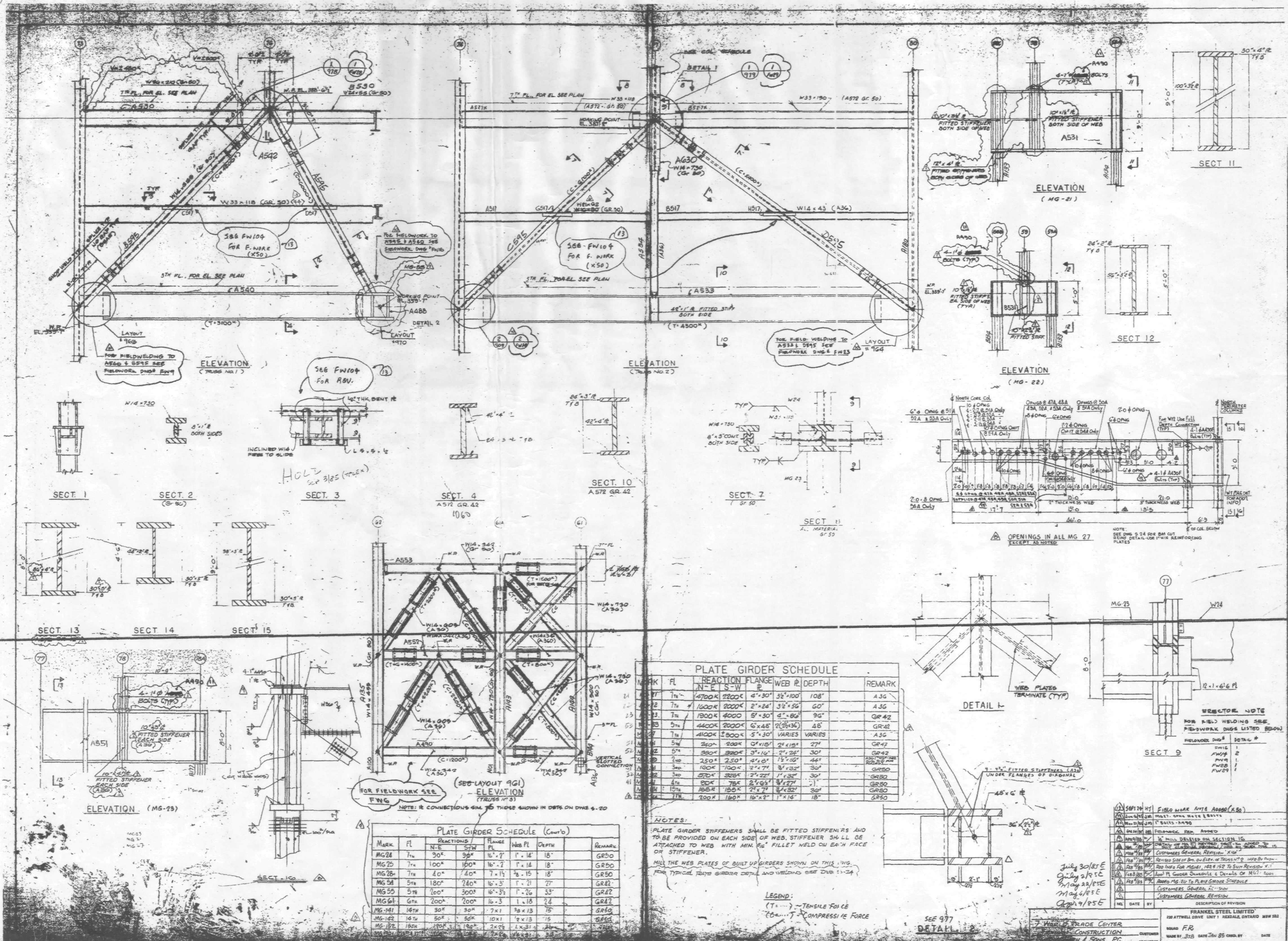

PLATE GIRDER SCHEDULE

MARK	FL	REACTION	FLANGE	WEB	DEPTH	REMARK	
A36	7in	14700K	2200K	4" x 30"	38" x 100"	108"	A36
A36	7in	1600K	2200K	2" x 24"	38" x 36"	60"	A36
GR42	7in	1900K	4000K	5" x 30"	4" x 86"	96"	GR42
GR42	5in	4400K	2000K	6" x 48"	2" (2" x 36")	48"	GR42
A36	7in	4100K	2300K	5" x 30"	VARIABLES	VARIABLES	A36
GR42	5in	240K	200K	0" x 18"	2" x 18"	27"	GR42
GR42	5in	380K	300K	3" x 14"	2" x 24"	30"	GR42
GR50	3in	250K	250K	4" x 6"	1" x 30"	44"	GR50
GR50	3in	100K	100K	2" x 7"	3/4" x 30"	30"	GR50
GR50	3in	500K	300K	2" x 24"	1" x 30"	30"	GR50
GR50	4in	50K	75K	2" x 6"	3/4" x 27"	27"	GR50
GR50	1 1/2in	155K	155K	2" x 7"	3/4" x 30"	30"	GR50
GR50	7in	200K	180K	16" x 2"	1" x 16"	18"	GR50

PLATE GIRDER SCHEDULE (Cont'd)

MARK	FL	REACTIONS	FLANGE	WEB	DEPTH	REMARK	
MG24	7in	90"	50"	1" x 7"	1" x 14"	18"	GR50
MG25	7in	100"	100"	1" x 7"	1" x 14"	18"	GR50
MG26	7in	40"	40"	7/8" x 15"	1" x 18"	18"	GR50
MG54	5in	180"	240"	1" x 3"	1" x 21"	77"	GR42
MG55	5in	100"	300"	1" x 3"	1" x 26"	55"	GR42
MG61	6in	200"	200"	1" x 3"	1" x 18"	24"	GR42
MG141	1 1/2in	30"	30"	7/8" x 13"	1" x 15"	15"	GR42
MG142	1 1/2in	50"	50K	1" x 13"	1" x 15"	15"	GR42
MG152	1 1/2in	100K	100K	1" x 13"	1" x 15"	15"	GR42

NOTES:
 PLATE GIRDER STIFFENERS SHALL BE FITTED STIFFENERS AND TO BE PROVIDED ON EACH SIDE OF WEB. STIFFENER SHALL BE ATTACHED TO WEB WITH MIN. 90° FILLET WELD ON EACH FACE OR STIFFENER.
 MIX THE WEB PLATES OF BUILT UP GIRDERS SHOWN ON THIS DRAWING.
 FOR TYPICAL TRUSS GIRDER DETAILS AND WELDING SEE DWG. 5-24

LEGEND:
 (T) --- TENSILE FORCE
 (C) --- COMPRESSIVE FORCE

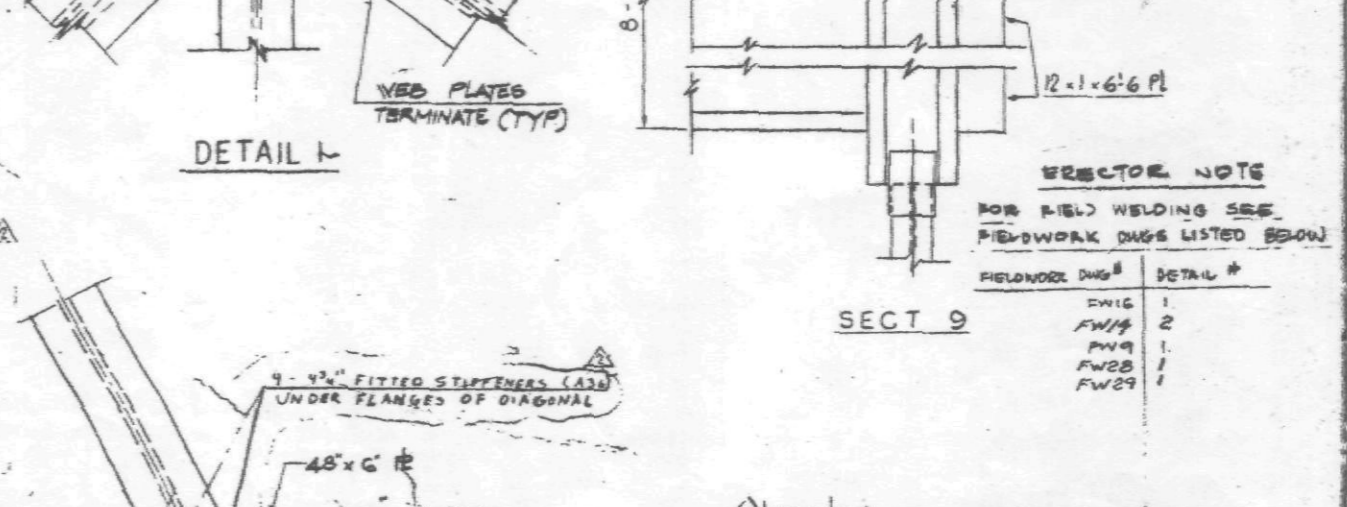

DETAIL 1
 SEE 977
 DATE: July 30/85
 DRAWN BY: [Signature]
 CHECKED BY: [Signature]
 PROJECT: [Project Name]